





## HAWAII KAI TOWNE CENTER

333 Keahole Street, Honolulu, Hawaii



### KEY HIGHLIGHTS

- Hawaii Kai Towne Center is located in one of the most upscale areas in the State
- Dominant center - waterfront mixed-use development
- Best In Class retailers and office users in the center create great synergy attributing to the constant flow of vehicular and foot traffic in the area
- Most office spaces offer open layouts, providing for space planning flexibility for any business
- Great ocean and mountain views from the center
- Ample customer parking and 24/7 security services
- Surrounded by many natural tourist attractions
- High income demographics

Contact: Cliff Ogata | (808) 351-9150 | [cogata@valuerockrealty.com](mailto:cogata@valuerockrealty.com) | [valuerockrealty.com](http://valuerockrealty.com)

18301 Von Karman Avenue, Suite 850, Irvine, CA 92612

The information contained has been secured from sources we believe to be reliable, but we make no representations or warranties, expressed or implied, as to the accuracy of the information. The receiving party must verify the information and bears all risk for any inaccuracies.





## HAWAII KAI TOWNE CENTER

333 Keahole Street, Honolulu, Hawaii



### PROPERTY DETAILS

Land Area	27+ Acres
GLA	458,696 Sq. Ft.
Parking	1,346 Stalls

### SURROUNDING DEMOGRAPHICS

	3 mile	5 mile	10 mile
Population	41,642	65,892	351,830
Average Income	\$155,116	\$152,921	\$109,507



Contact: Cliff Ogata | (808) 351-9150 | [cogata@valuerockrealty.com](mailto:cogata@valuerockrealty.com) | [valuerockrealty.com](http://valuerockrealty.com)

18301 Von Karman Avenue, Suite 850, Irvine, CA 92612

The information contained has been secured from sources we believe to be reliable, but we make no representations or warranties, expressed or implied, as to the accuracy of the information. The receiving party must verify the information and bears all risk for any inaccuracies.



## HAWAII KAI TOWNE CENTER

333 Keahole Street, Honolulu, Hawaii



Contact: Cliff Ogata | (808) 351-9150 | [cogata@valuerockrealty.com](mailto:cogata@valuerockrealty.com) | [valuerockrealty.com](http://valuerockrealty.com)

18301 Von Karman Avenue, Suite 850, Irvine, CA 92612

The information contained has been secured from sources we believe to be reliable, but we make no representations or warranties, expressed or implied, as to the accuracy of the information. The receiving party must verify the information and bears all risk for any inaccuracies.



## HAWAII KAI TOWNE CENTER TENANT SUMMARIES

333 Keahole Street, Honolulu, Hawaii

### HAWAII KAI TOWNE CENTER

Unit	Tenant	Square Feet
1	Costco Wholesale	138,859
2A	Costco Tire	5,790
2A1	Diagnostic Laboratory Services	1,987
2B1	Taco Del Mar	517
2B2	Go Wireless - Verizon	524
2B3	Great Clips	946
2B4	Lanikai Juice	992
2B5	General Nutrition Center	992
2B6	Starbucks Coffee	958
2B7	Sally Beauty Supply	1,294
2B8	Maile's Thai Bistro	1,868
2B9	Aloha Medical Supply	570
2B10	Sushiman	849
2C1	Panda Express	1,871
2D	Ross Dress For Less	22,013
2E2	T-Mobile	1,219
2E3	Ramen-Ya	1,233
2E4	Instyle Nails	1,240
2E5/6	American Savings Bank	2,466
2E7	Jersey Mike's Subs	1,240
2E8	Koa Pancake House	1,227
2E9/10	Tex 808	2,442
3	City Mill	36,627
4	Raising Cane's Chicken Fingers	3,025

### HAWAII KAI CORPORATE PLAZA

Unit	Tenant	Square Feet
GROUND FLOOR		
101	Satellite City Hall	1,877
104	Larry's Auto Parts	2,019
107	Central Pacific Bank	2,323
108A	Title Guaranty Escrow	951
108B	Mission Financial Group	402
110	Roy's Restaurant	2,000
114	Hawaii Life	2,508
114A	Island Urgent Care	2,127
114C	Eye Doctors Hawaii	1,966
<b>116</b>	<b>Available</b>	<b>470</b>
117	Surf Paws Animal Hospital	1,856
SECOND FLOOR		
200,207	ProService Hawaii	8,256/208,209
212	Van Buren & Shimizu	1,155
213/215	Roy's Restaurant	8,150
<b>223</b>	<b>Available</b>	<b>1,173</b>
224	Intellectual Services	2,014
<b>225</b>	<b>Available</b>	<b>1,104</b>
THIRD FLOOR		
300	ProService	10,806
300	ProService - Mezzanine	2,524
PAD		
Pad Site	Aloha Gas/ Aloha Island Mart	21,440

### HAWAII KAI EXECUTIVE PLAZA

Unit	Tenant	Square Feet
GROUND FLOOR		
101A	Hawaii Kai Salon & Day Spa	773
101B	Security/Maintenance Office	489
102	Douglas Wrobel, DDS	915
103	Aloha Personal Training	916
104	Edward Jones	914
105	Hawaii Kai Family Dentistry	883
106	Hawaii Kai Chiropractic	1,300
107	Koko Head Dental	1,101
<b>108</b>	<b>Available</b>	<b>1,645</b>
110	Hawaii State Federal Credit Union	2,988
111	Kaiser Permanente	9,121
122	OsteoStrong	2,006
SECOND FLOOR		
201	Cambe Corp	1,212
202	Lyle Matsuo DDS	845
203	Insurance Professionals of Hawaii	875
204	State Farm Insurance	876
205	HKTC Management Office	1,133
206	Hawaii American Water	923
207	Dr. Madison Bell	523
208	Diehl & Weger Attys at Law	659
210	Collateral Analytics	4,962
215	Hawaii Mortgage Experts	1,630
216	Hawaii Pacific Dental Group	1,095
216A	Periodontics Hawaii	1,328
217	Hawaii Dermatology Centers	3,095
218	Frith-Smith & Archibald	1,104
PADS		
EP-II	Outback Steakhouse	7,005
Lot 9	Extra Space Storage	120,000

Contact: Cliff Ogata | (808) 351-9150 | cogata@valuerockrealty.com | valuerockrealty.com

18301 Von Karman Avenue, Suite 850, Irvine, CA 92612

The information contained has been secured from sources we believe to be reliable, but we make no representations or warranties, expressed or implied, as to the accuracy of the information. The receiving party must verify the information and bears all risk for any inaccuracies.



# HAWAII KAI TOWNE CENTER

333 Keahole Street, Honolulu, Hawaii

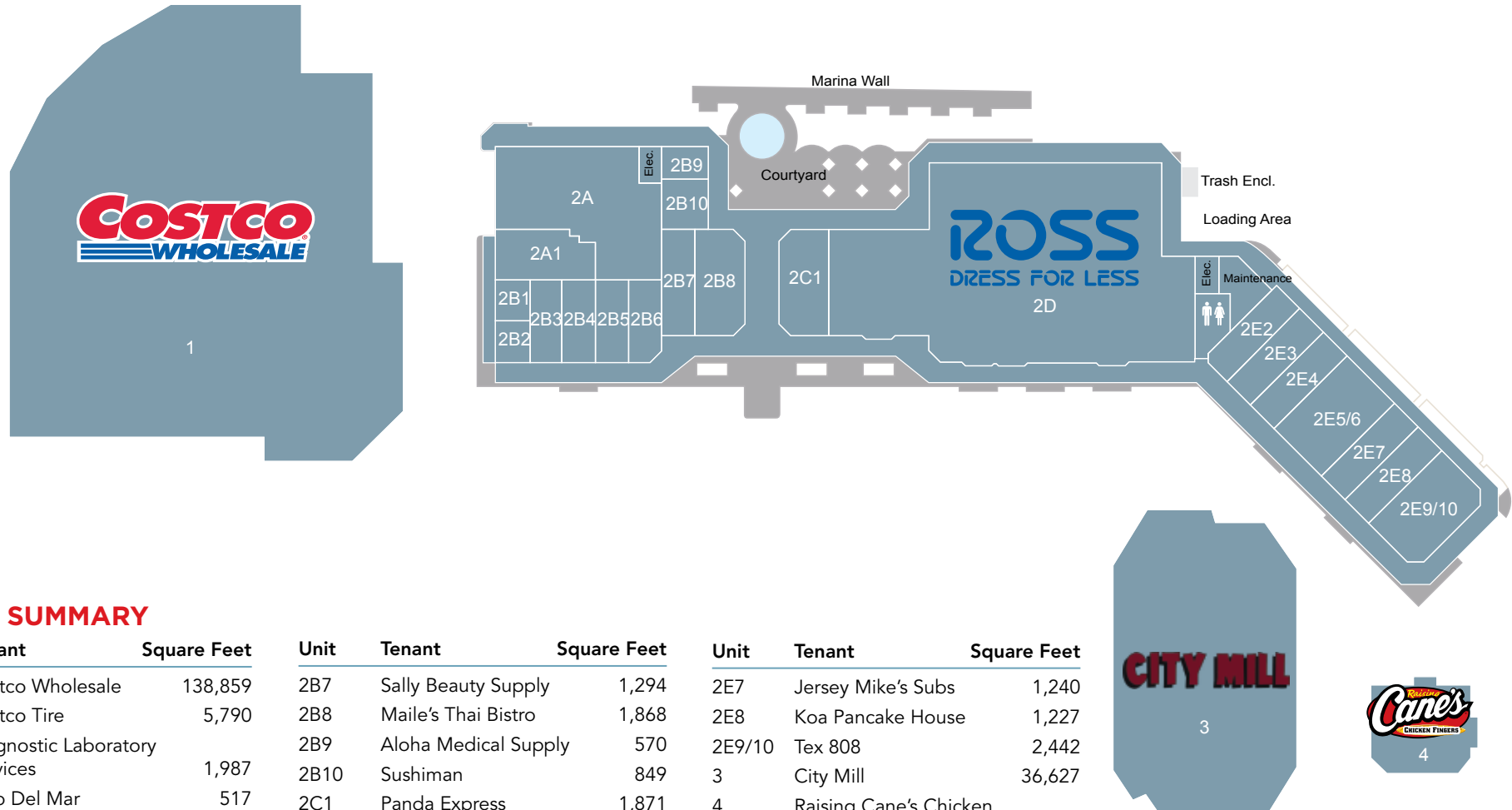

## TENANT SUMMARY

Unit	Tenant	Square Feet	Unit	Tenant	Square Feet	Unit	Tenant	Square Feet
1	Costco Wholesale	138,859	2B7	Sally Beauty Supply	1,294	2E7	Jersey Mike's Subs	1,240
2A	Costco Tire	5,790	2B8	Maile's Thai Bistro	1,868	2E8	Koa Pancake House	1,227
2A1	Diagnostic Laboratory Services	1,987	2B9	Aloha Medical Supply	570	2E9/10	Tex 808	2,442
2B1	Taco Del Mar	517	2B10	Sushiman	849	3	City Mill	36,627
2B2	Go Wireless - Verizon	524	2C1	Panda Express	1,871	4	Raising Cane's Chicken Fingers	3,025
2B3	Great Clips	946	2D	Ross Dress For Less	22,013			
2B4	Lanikai Juice	992	2E2	T-Mobile	1,219			
2B5	General Nutrition Center	992	2E3	Ramen-Ya	1,233			
2B6	Starbucks Coffee	958	2E4	Instyle Nails	1,240			
			2E5/6	American Savings Bank	2,466			

Contact: Cliff Ogata | (808) 351-9150 | [cogata@valuerockrealty.com](mailto:cogata@valuerockrealty.com) | [valuerockrealty.com](http://valuerockrealty.com)

18301 Von Karman Avenue, Suite 850, Irvine, CA 92612

The information contained has been secured from sources we believe to be reliable, but we make no representations or warranties, expressed or implied, as to the accuracy of the information. The receiving party must verify the information and bears all risk for any inaccuracies.



# HAWAII KAI CORPORATE PLAZA

333 Keahole Street, Honolulu, Hawaii

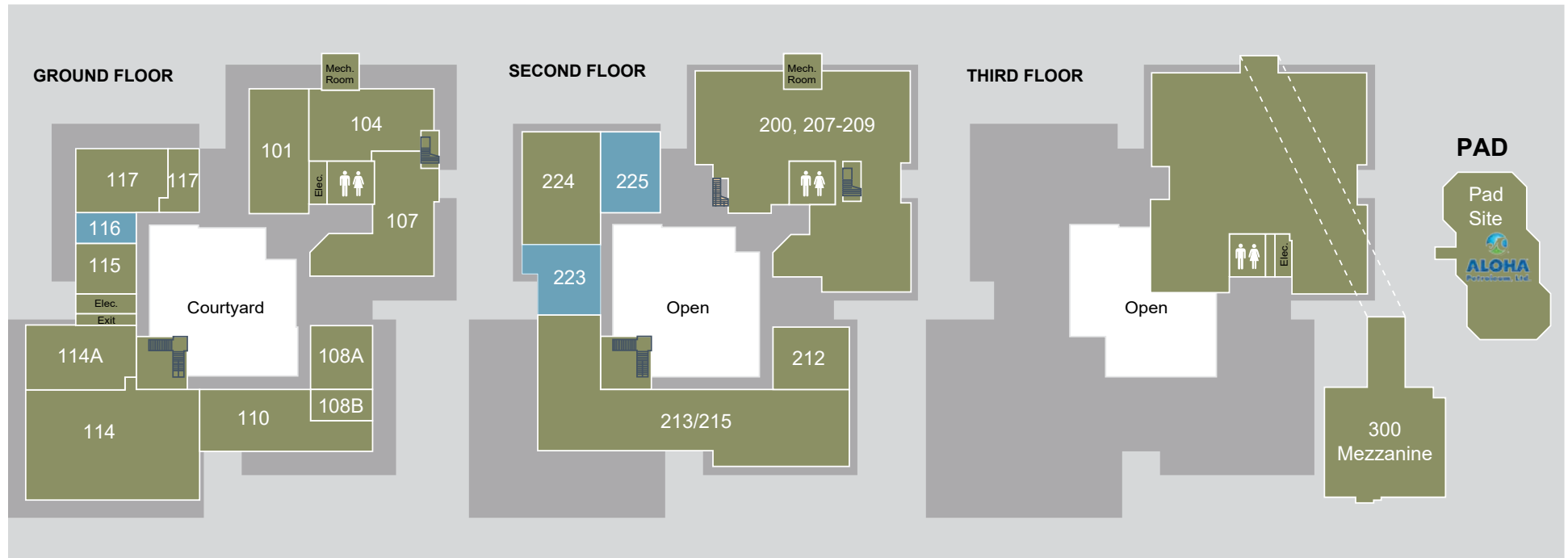

## TENANT SUMMARY

Unit	Tenant	Square Feet
FIRST FLOOR		
101	Satellite City Hall	1,877
104	Larry's Auto Parts	2,019
107	Central Pacific Bank	2,323
108A	Title Guaranty Escrow	951
108B	Mission Financial Group	402
110	Roy's Restaurant	2,000
114	Hawaii Life	2,508
114A	Island Urgent Care	2,127

Unit	Tenant	Square Feet
FIRST FLOOR (cont)		
114C	Eye Doctors Hawaii	1,966
<b>116</b>	<b>Available</b>	<b>470</b>
117	Surf Paws Animal Hospital	1,856
SECOND FLOOR		
200/207	ProService Hawaii	8,256
208/209	ProService Hawaii	2,014
212	Van Buren & Shimizu	1,155
213/215	Roy's Restaurant	8,150
<b>223</b>	<b>Available</b>	<b>1,173</b>

Unit	Tenant	Square Feet
SECOND FLOOR (cont)		
224	Intellectual Services	2,014
<b>225</b>	<b>Available</b>	<b>1,104</b>
THIRD FLOOR		
300	ProService	10,806
300	ProService - Mezzanine	2,524
PAD		
Pad Site	Aloha Gas/ Aloha Island Mart	21,440

Contact: Cliff Ogata | (808) 351-9150 | cogata@valuerockrealty.com | valuerockrealty.com

18301 Von Karman Avenue, Suite 850, Irvine, CA 92612

The information contained has been secured from sources we believe to be reliable, but we make no representations or warranties, expressed or implied, as to the accuracy of the information. The receiving party must verify the information and bears all risk for any inaccuracies.





# HAWAII KAI EXECUTIVE

333 Keahole Street, Honolulu, Hawaii

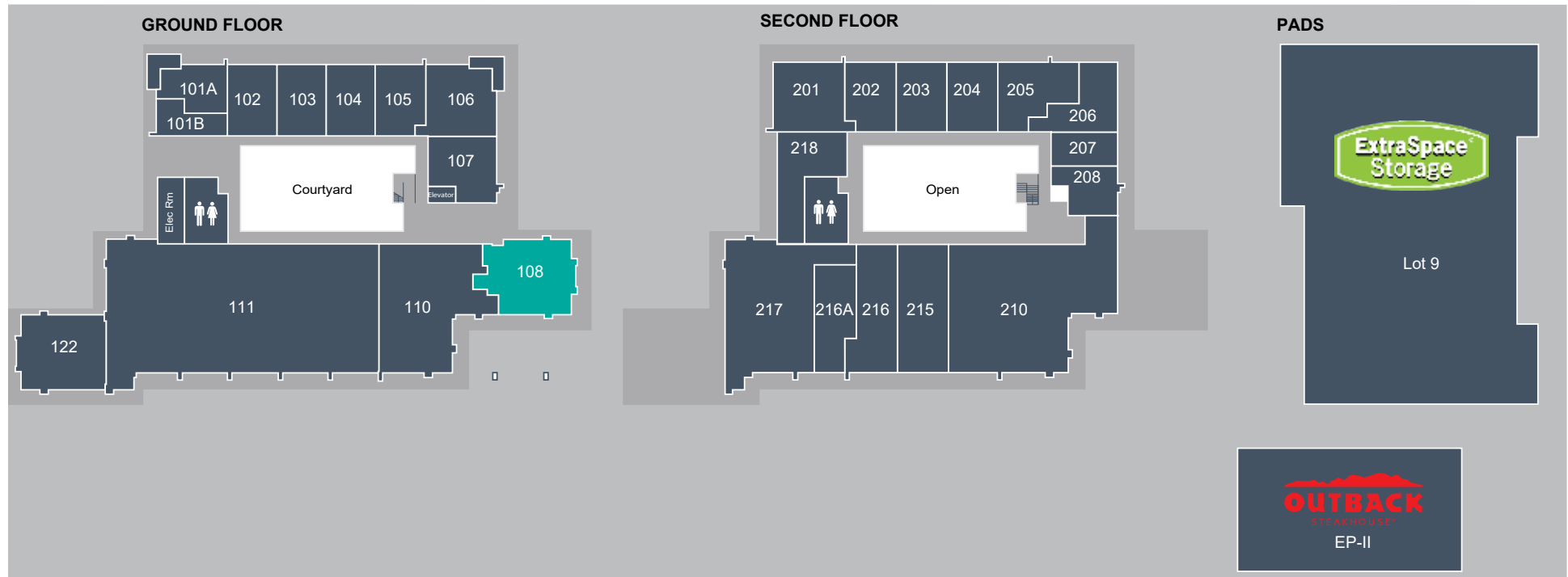

## TENANT SUMMARY

Unit	Tenant	Square Feet
<b>FIRST FLOOR</b>		
101A	Hawaii Kai Salon & Day Spa	773
101B	Security/Maintenance Office	489
102	Douglas Wrobel, DDS	915
103	Aloha Personal Training	916
104	Edward Jones	914
105	Hawaii Kai Family Dentistry	883
106	Hawaii Kai Chiropractic	1,300
107	Koko Head Dental	1,101
<b>108</b>	<b>Available</b>	<b>1,645</b>
110	Hawaii State Federal Credit Union	2,988

Unit	Tenant	Square Feet
<b>FIRST FLOOR (cont)</b>		
111	Kaiser Permanente	9,121
122	OsteoStrong	2,006
<b>SECOND FLOOR</b>		
201	Cambe Corp	1,212
202	Lyle Matsuo DDS	845
203	Insurance Professionals of Hawaii	875
204	State Farm Insurance	876
205	HKTC Management Office	1,133
206	Hawaii American Water	923
207	Dr. Madison Bell	523
208	Diehl & Weger Attys at Law	659

Unit	Tenant	Square Feet
<b>SECOND FLOOR (cont)</b>		
210	Collateral Analytics	4,962
215	Hawaii Mortgage Experts	1,630
216	Hawaii Pacific Dental Group	1,095
216A	Periodontics Hawaii	1,328
217	Hawaii Dermatology Centers	3,095
218	Frith-Smith & Archibald	1,104
<b>PADS</b>		
EP-II	Outback Steakhouse	7,005
Lot 9	Extra Space Storage	120,000

Contact: Cliff Ogata | (808) 351-9150 | cogata@valuerockrealty.com | valuerockrealty.com

18301 Von Karman Avenue, Suite 850, Irvine, CA 92612

The information contained has been secured from sources we believe to be reliable, but we make no representations or warranties, expressed or implied, as to the accuracy of the information. The receiving party must verify the information and bears all risk for any inaccuracies.

